

U2T User manual

### Danger and Warning

- Please read the user manual before first use
- DO NOT shine light directly into eyes. This may cause temporary blindness or cause permanent damage to the eyes.
- DO NOT cover the light head when the flashlight is on or place the light head on the ground. The heat dispersion of the light may cause damage to the flashlight itself or even result in burning other objects.
- Keep out of reach of children.
- DO NOT activate the turbo mode constantly to prevent the flashlight body from overheating and hurt the user's hand.

### Inside the box

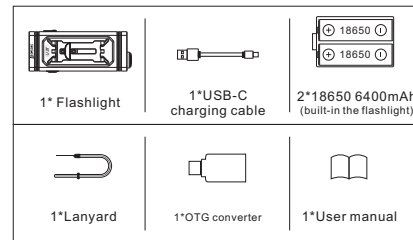

### Optional Accessory

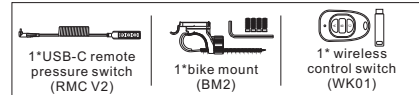

### Specification

FL 1 STANDARD	Turbo	High	Medium	Low	ECO	Strobe	SOS
Output	5000LM	2000LM	500LM	180LM	12LM	5000LM	500LM
Runtime	4H	4.7H	6.5H	19H	150H	--	--
Beam Intensity	28.875cd	12.500cd	3.100cd	1187cd	66cd	--	--
Beam Distance	340m	224m	111m	69m	16m	--	--
LED	3* Lumina SST40 LED						
Reflector	Smooth Reflector						
Battery Source	Built-in 2*18650 lithium battery (Total 6400mAh)						
Charging	5V/3A USB-C charging						
Impact Distance	1.5m						
Waterproof	IP68(underwater 2m)						
Material	Aerospace 6061 Aluminum Alloy						
Dimension	107(L)×43(W)×23.9(H)mm						
Net Weight	221g(include battery)						

The above data has been measured in accordance with international flashlight testing standards ANSI/NEMA FL1 using 2\*1NR 3.7V/ 3200mAh 18650 Lithium battery (total 6400mAh) under laboratory conditions.

### Product Overview

The SPERAS U2T is a multifunctional flashlight that delivers a powerful 5000lm max output and reaches a 340m beam distance from its 3 Lumina SST40 LEDs and advanced driver. The rectangle shape provides a functional, modern and sturdy look and also enhances heat dissipation. USB-C 5V/3A ensures fast charging in under 2.25 hours for a full charge. The 2 built-in INR 3200mAh 18650 batteries provide a runtime in excess of 150 hours. With the functional bike mount, it is easy to attach or remove the light to your bicycle. An added feature is the wireless USB-C remote pressure switch that can free up your hands. The U2T is an ideal flashlight for camping, hiking, outdoor and everyday use.

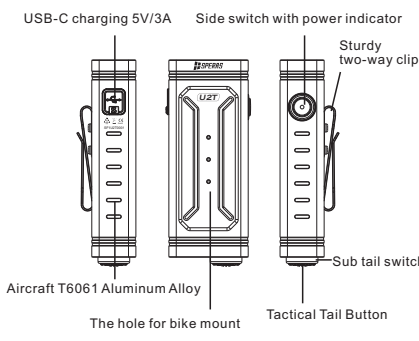

### Operation Instructions

- #### Side switch
- ON/OFF:** Long press the side button to turn on the flashlight (enter the memory mode); long press the button again to turn off.
  - Change modes:** when the flashlight is ON, click the side button to change mode and circle(ECO-Low-Med-High-Turbo) with clicks
  - Strobe/SOS:** at any state, double click to strobe, another double click will enter the SOS mode; click again will back the state before strobe.
  - Lock/Unlock:** in the OFF state, press down the side switch and keep for 2 seconds to lock the flashlight; quickly triple-click to unlock the flashlight. When lock or unlock, the main light will flash twice to remind. After locking, the LED indication will quickly flash in orange if operate the switch.
- #### Tactical tail switch
- In the OFF state, tap the tail button to TURBO, release, OFF.
  - In the OFF state, press down the tail button to TURBO.
  - In the ON state, press down the tail button to OFF.
- #### Sub tail switch
- In the OFF state, tap the sub tail switch to STROBE, release, OFF.
  - In the ON state, tap the sub tail switch to change mode(ECO-Low-Med-High-Turbo)
  - In the ON state, tap the sub tail switch and keep for 0.3 seconds to enter the STROBE mode, release to back to ON state.

### Charging & Discharging

- #### Charging:
- Open the USB rubber, insert the USB-C cable, connect your 5V/3A adapter then can charge the flashlight.
  - When charging, the LED indicator shows red; when it's fully charged, shows green.
  - When charging, press down the side switch or tail button to enter the ECO mode, press then release, turn OFF.

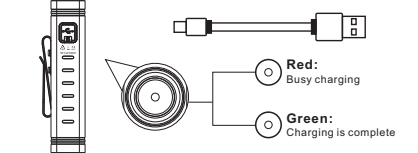

**Discharging:**

- Insert the OTG connector to the USB-C port, connect the cable and then can discharge (max 5V/3A) to phone or other electronics.

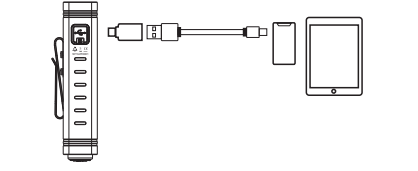

### How To Install The Bike Mount

- Press the latch and then remove the center part.
- Install the center part with 3 pcs screws on the flashlight.
- Install the whole bike mount on the bike.
- Install the flashlight on the bike mount.

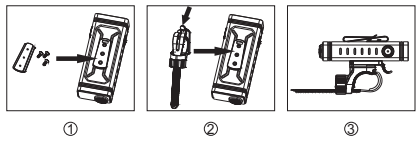

### How to use the Remote Pressure Switch

- #### S1: ON/OFF/Momentary ON
- In the OFF state, click the S1 button, the flashlight will turn on (enter the memory mode); click again, it will turn off.
  - In the OFF state, long press the S1 button, the flashlight will turn on (enter the memory mode), release will turn off.
- #### S2/S3 Key
- The S2/S3 have the same function
  - When in the OFF state, press the any of S2 or S3 button, the flashlight will enter strobe mode, release will back OFF state.
  - In the ON state, click the any of S2 or S3 button, the flashlight will change mode and circle with clicks(ECO-Low-Med-High-Turbo)
  - In the ON state, long press for 0.5 seconds, it will strobe, release will back to the ON state.

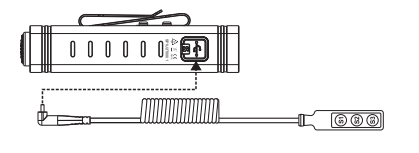

### How to use the wireless switch

- Insert the acceptor to the USB-C port on the flashlight, and then can operate the emitter switch.
- A Key: ON/OFF/Momentary ON**
- In the OFF state, click the A button, the flashlight will turn on (enter the memory mode); click again, it will turn off.
  - In the OFF state, long press the A button, the flashlight will turn on (enter the memory mode), release will turn off.
- B/C Key**
- The B/C have the same function
  - When in the OFF state, press the any of B or C button, the flashlight will enter STROBE mode, release will back OFF state.
  - In the ON state, click the any of B or C button, the flashlight will change mode and circle with clicks(ECO-Low-Med-High-Turbo)
  - In the ON state, long press for 0.5 seconds, it will enter STROBE, release will back to the ON state.



### Power Indicator

Turn on the flashlight, the LED indication will automatically monitor the power and show as follow:

- \* Green: more than 70%
- \* Orange: 30%-70%
- \* Red: 5%-30%
- \* Red Flash: less than 5%

### Warranty

- 30 days free replacement:** We will repair or replace a light within 30 days of purchase if it is afflicted with a manufacturing defect. If the problem calls for a replacement, we will replace the light with the same model as the one sent in. If the model has been discontinued, customers will receive a product with similar or improved performance.
- 5 years warranty:** We offer free repair within 5 years of purchase if problems develop with normal use.
- Limited lifetime warranty:** If you develop a problem with the purchase, we will charge for parts. The total repair fee is assessed according to the cost of the replaced materials.
- Contact Your Dealer First:** You may provide your SPERAS Warranty Card, purchase invoice, receipt or other evidence from the sellers when you purchasing our lights and contact your dealers directly for warranty service, and SPERAS will provide dealers with service support.

### Beyond Warranty

Free warranty DOES NOT cover any damage or failure caused by:

- Normal wear up
- Damages caused by disassembling, modifying the flashlight
- Damages caused by rough operation or misuse
- Improper maintenance or repairs by anyone other than an authorized retailer or SPERAS itself

**Shenzhen Speras Lighting Co., Ltd**  
 Add: 4F, Building G, Gangshen Innovation Park, Huangning Road, Dalang Street, Longhua District, Shenzhen, China, China. 518109  
 Tel.: +86-755-2107-2597  
 Email: info@speraslight.com  
 Website: www.sperasflashlight.com



Product Model No.: \_\_\_\_\_

Series No.: \_\_\_\_\_

Date of Purchase: \_\_\_\_\_

Signature/Dealer Stamp: *PED LIGHT JAPAN*

**Thank you for choosing SPERAS.**  
 The SPERAS flashlight is covered by a 5-year warranty from the date of purchase. Please ask the seller/dealer to fulfill the date of purchase and sign/stamp the warranty card after purchase!  
 Contact the seller/dealer of SPERAS first if need help!

**Notice:** The warranty covers manufacturer defects solely and will be invalid if the flashlight is subjected to work by an unauthorized party.

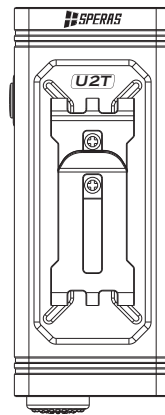

U2T 使用说明书

### 危險和警告

- 首次使用，請詳細閱讀說明書。
- 請勿將光線直射眼睛。這可能會導致暫時失明或對眼睛造成永久性損傷。
- 請勿在手電筒開啟時遮蓋燈頭，或將燈頭放在地上。光的熱擴散可能會導致手電筒本身的損壞，甚至導致其他物體燃燒。
- 請放在兒童接觸不到的地方。
- 請勿持續開啟高光模式，以免手電筒體過熱傷手。

### 套裝標配

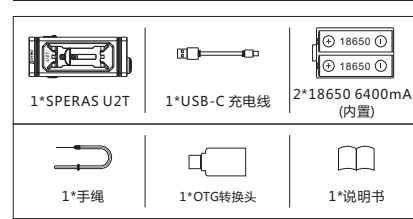

### 可選配件



### 產品參數

FL 1 STANDARD	極亮檔	高亮檔	中亮檔	低亮檔	ECO	摩閃	SOS
輸出流明	5000LM	2000LM	500LM	180LM	12LM	5000LM	500LM
續航	4H	4.7H	6.5H	19H	150H	--	--
光通	28.875cd	12.500cd	3.100cd	1187cd	66cd	--	--
射程	340m	224m	111m	69m	16m	--	--
燈珠	3* Lumina SST40 LED						
燈杯	光面反射杯						
電池	內置2*18650電池 (共6400mAh)						
充電	5V/3A USB-C 充電						
防護	1.5m						
防水等級	IP68						
材料	T6061 鋁合金						
尺寸	107(L)×43(W)×23.9(H)mm						
淨重	221g(含內置電池)						

以上數據是按照國際手電筒測試標準ANSI/NEMA FL1, 使用 SPERAS 2\*18650內置電池(共6400mAh)在實驗室條件下測得。

### 產品簡介

SPERAS U2T 是一款多功能手電筒，搭配3個LuminaSST40燈珠以及先進設計，最靈輸出可達5000流明和340米射程。矩形外形使之看起來更堅固，更實用，更現代，並增強了手電筒的散熱性。USB-C 5V/3A快充，2.25小時可充滿。內置2\*18650 3200mAh電池，可提供15小時長運行時間。選配的自行車支架，專且自用，可實現快速安裝和拆卸的功能。無線遙控鼠尾，可解放雙手。U2T是一款適合露營、遠足、戶外和日常使用的理想手電筒。

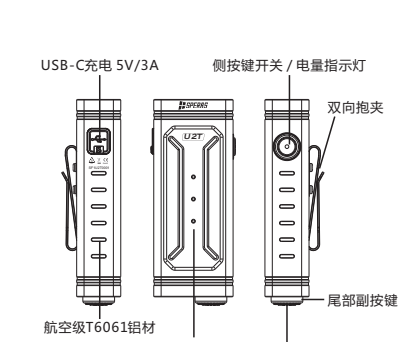

### 操作

- #### 側按鍵操作方式
- 打開/關閉:** 長按側按鍵可打開手電筒 (此時進入的是記憶檔); 長按側按鍵, 關閉手電筒。
  - 換檔:** 當手電筒在打開的狀態下, 单击側按鍵可循環切換档位: ECO-低檔-中檔-高檔-極亮檔。
  - 爆閃/SOS:** 在任意狀態下, 双击可進入爆閃, 再双击可進入 SOS, 再单击可返回到爆閃前的狀態。
  - 鎖定/解鎖:** 手電筒在關閉狀態下, 按下側按鍵2秒即可鎖定手電筒; 快速三次单击以解鎖手電筒。鎖定或解鎖時, 主燈會閃爍兩次提醒。鎖定後按下任意按鍵橙色指示燈快速閃爍提示。
- #### 尾部分開開關
- 在手電筒關閉狀態下, 輕按戰術開關, 進入極亮檔, 松手, 手電筒關閉。
  - 在手電筒關閉狀態下, 按下戰術開關, 進入極亮檔。
  - 在手電筒打開狀態下, 按下戰術開關, 手電筒關閉。
- #### 尾部分開開關
- 在手電筒關閉狀態下, 輕碰尾部分開開關可切換模式 (ECO-低-中-高-極亮)
  - 在手電筒打開狀態下, 輕碰尾部分開開關可切換模式 (ECO-低-中-高-極亮)
  - 在手電筒打開狀態下, 輕碰尾部分開開關保持0.3秒進入爆閃模式, 松手返回之前的狀態。

### 充電和放電

- 打開USB鞋套, 插入USB-C線, 連接5V/3A適配器, 可給手電筒充電。
- 充電中, 指示燈為紅色; 充滿, 指示燈為綠色。
- 充電過程中, 按下戰術開關或側按鍵, 可進入ECO檔, 再次按下, 關閉手電筒。

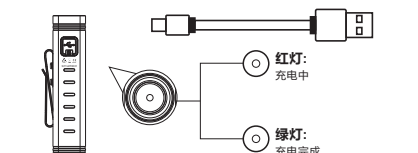

**Discharging:**

- 連接上OTG轉接口, 插上USB線, 則可給手機或其他電子設備充電。

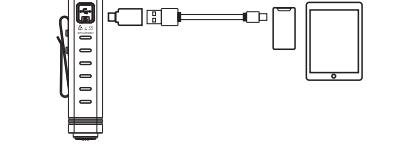

### 如何安裝自行車夾

- 按壓在鎖扣, 向下滑便可拆下中間件。
- 用3顆螺絲將中間件固定在手電筒上。
- 將自行車夾子固定在自來車上。
- 再將手電筒固定在自行車夾子上。

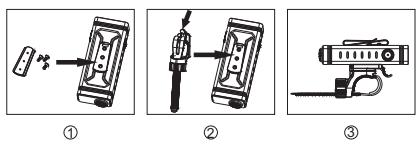

### 如何使用遙控鼠尾(可選配件)

- 使用遙控器之前, 需要先把接收器插入手電筒的TYPE-C口。
- A: 可控制打開/關閉/開亮**
- 在關閉狀態下, 单击A按鍵, 手電筒打開 (進入記憶檔); 再单击, 可關閉手電筒。
  - 在關閉狀態下, 長按A按鍵, 手電筒打開 (進入記憶檔); 松手, 關閉。
- B/C:**
- B和C按鍵功能一樣
  - 在關閉狀態下, 按壓B/C按鍵, 手電筒會進入爆閃, 松手, 關閉。
  - 在打開狀態下, 单击B/C按鍵, 手電筒可切換檔位 (在ECO-低檔-中檔-高檔-極高檔循環)。
  - 在打開狀態下, 長按B/C按鍵, 手電筒會爆閃, 松手返回到打開狀態。
- S1: 可控制打開/關閉/開亮**
- 在關閉狀態下, 单击S1按鍵, 手電筒打開 (進入記憶檔); 再单击, 可關閉手電筒
  - 在關閉狀態下, 長按S1按鍵, 手電筒打開 (進入記憶檔); 松手, 關閉。
- S2/S3:**
- S2和S3按鍵功能一樣
  - 在關閉狀態下, 按壓S2/S3按鍵, 手電筒會進入爆閃, 松手, 關閉。
  - 在打開狀態下, 单击S2/S3按鍵, 手電筒可切換檔位 (在ECO-低檔-中檔-高檔-極高檔循環)。
  - 在打開狀態下, 長按S2/S3按鍵, 手電筒會爆閃, 松手返回到打開狀態。

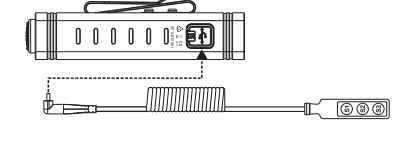

### 如何使用無線遙控器(可選配件)

- 使用遙控器之前, 需要先把接收器插入手電筒的TYPE-C口。
- A: 可控制打開/關閉/開亮**
- 在關閉狀態下, 单击A按鍵, 手電筒打開 (進入記憶檔); 再单击, 可關閉手電筒。
  - 在關閉狀態下, 長按A按鍵, 手電筒打開 (進入記憶檔); 松手, 關閉。
- B/C:**
- B和C按鍵功能一樣
  - 在關閉狀態下, 按壓B/C按鍵, 手電筒會進入爆閃, 松手, 關閉。
  - 在打開狀態下, 单击B/C按鍵, 手電筒可切換檔位 (在ECO-低檔-中檔-高檔-極高檔循環)。
  - 在打開狀態下, 長按B/C按鍵, 手電筒會爆閃, 松手返回到打開狀態。

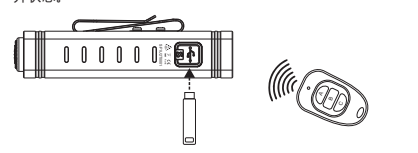

### 電量提示

開機後側邊指示燈會自動指示電量5秒, 電量如下:

- 綠燈: 大於70%
- 橙燈: 30%-70%
- 紅燈: 5%-30%
- 紅閃: 小於5%

### 保修服務

- 30 天免費更換:** 如果器具存在製造缺陷, 我們將允許在購買后 30 天內維修或更換燈具。如需更換, 我們將更換同型號產品。如果該型號已停产, 客戶將收到性能相似或改進的產品。
- 5 年保修:** 購買后 5 年內正常使用出現問題, 我們提供免費維修。
- 終身保修:** 如果購買 5 年後出現問題, 我們將收取零件費用。總維修費根據更換材料的成本進行評估。
- 首先聯繫經銷商:** 您可以在購買我們的時提供您的 SPERAS 保修卡、購買發票、收據或賣家的其他證明, 並聯繫您的經銷商進行保修服務, SPERAS 將為經銷商提供服務支持;

### 不予保修範圍

- 免費保修不包括以下原因造成的任何損壞或故障:
  - 正常磨損
  - 拆卸、改裝手電筒造成的損壞
  - 粗暴操作或誤操作造成的損壞
  - 由授權零售商或SPERAS本身以外的任何人進行不當維護或維修

### 深圳市思貝照明有限公司

地址: 深圳市龍華新區大浪街道華南路口  
 鴻源創源新區G棟420-424  
 電話: +86-755-2107-2597  
 網址: www.sperasflashlight.com  
 郵箱: info@speraslight.com  
 CE RoHS RECYCLE



產品型號: \_\_\_\_\_

產品序列號: \_\_\_\_\_

購買日期: \_\_\_\_\_

代理商簽名/蓋章: \_\_\_\_\_

**感謝您選擇 SPERAS.**  
 SPERAS 手電筒自購買之日起享有 5 年保修。  
 購買後請要求賣家/經銷商填寫購買日期並在保修卡上簽字/蓋章!  
 如果需要幫助, 請先聯繫 SPERAS 手電筒的賣家/經銷商!

注意: 保修條款僅適用于製造商缺陷。

双面印刷 折后尺寸60x90mm